

CONCRETE TWO WAY  
DRIVE OPENING  
DETAIL M

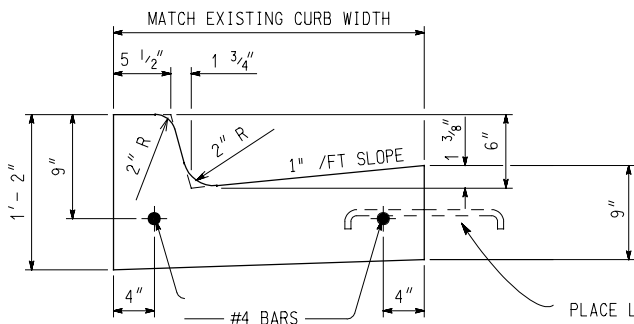

CONCRETE CURB & GUTTER  
DETAIL F

CONCRETE REQUIRED 0.0737 CYD/LFT (MAX)

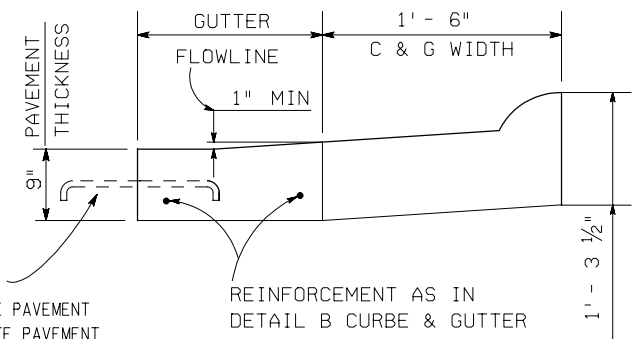

SECTION A-A

PLACE LANE TIE IF  
REINFORCED CONCRETE PAVEMENT  
OR BIT OVER CONCRETE PAVEMENT  
(SEE STD PLAN 41 SERIES)

REINFORCEMENT AS IN  
DETAIL B CURB & GUTTER

UTILITIES - PERMITS SECTION  
REAL ESTATE DIVISION



PERMIT NO. \_\_\_\_\_  
TRUNKLINE \_\_\_\_\_  
NAME OF PERMIT \_\_\_\_\_  
APPLICANT \_\_\_\_\_

PERMIT ATTACHMENT FOR  
COMMERCIAL DRIVEWAY  
CURBED TRUNKLINE

04-11-01  
PLAN DATE

PA-06

SHEET  
01 OF 02

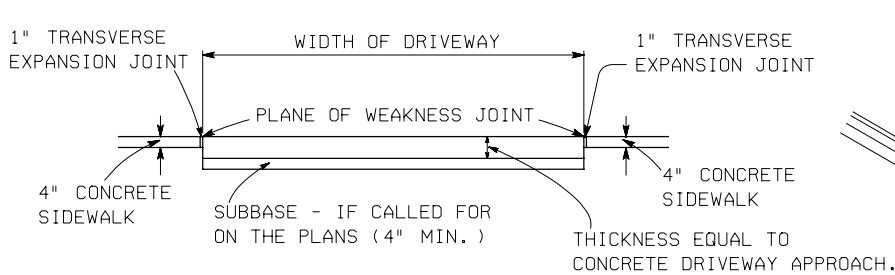

THICKENED CONCRETE SIDEWALK

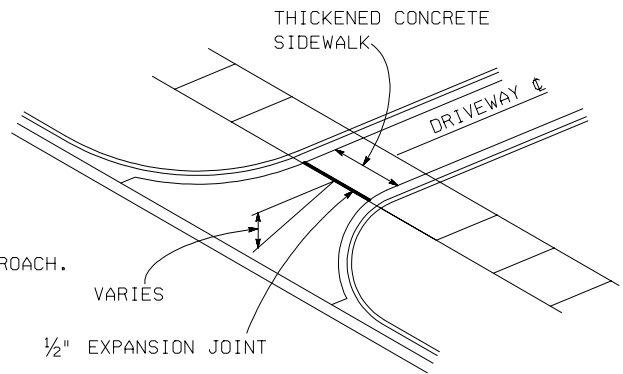

DETAIL M DRIVEWAY WITH SIDEWALK

NOTES

1. THE SURFACE SHALL BE EQUAL TO OR BETTER THAN THE FOLLOWING:
  - a. \_\_\_\_\_ INCH BITUMINUS MIXTURE \_\_\_\_\_ TOP  
 \_\_\_\_\_ INCH BITUMINUS MIXTURE \_\_\_\_\_ LEVELING  
 \_\_\_\_\_ INCH BITUMINUS MIXTURE \_\_\_\_\_ BASE  
 \_\_\_\_\_ INCH COMPACTED GRAVEL OR CRUSHED STONE  
 \_\_\_\_\_ INCH SUBBASE COMPATIBLE WITH THAT USED ON THE HIGHWAY
  - b. \_\_\_\_\_ OF REINFORCED CONCRETE ON \_\_\_\_\_ INCH OF COMPACTED GRAVEL OR CRUSHED STONE AND \_\_\_\_\_ SUBBASE COMPATIBLE WITH THAT USED ON THE HIGHWAY.
  - c. CONCRETE GRADE P1 SHALL BE USED.
2. ALL WORK WITHIN THE RIGHT OF WAY SHALL BE DONE IN ACCORDANCE WITH CURRENT MICHIGAN DEPARTMENT OF TRANSPORTATION STANDARD SPECIFICATIONS FOR CONSTRUCTION AND ACCORDING TO THE ADMINISTRATIVE RULES OF ACT 200, P.A. OF 1969.
3. DISTURBED AREAS SHALL BE RESTORED WITH TOPSOIL AND SEED OR SOD ONLY. MINIMUM OF 3 INCHES OF TOPSOIL REQUIRED.
4. A DRIVEWAY SHALL BE CONSTRUCTED SO THAT IT DOES NOT ADVERSELY AFFECT THE HIGHWAY DRAINAGE. THE DRAINAGE AND THE STABILITY OF THE HIGHWAY SUBGRADE SHALL NOT BE ALTERED BY DRIVEWAY CONSTRUCTION OR ROADSIDE DEVELOPMENT.
5. CURB IS TO EXTEND TO ROW LINE OR A MINIMUM OF 10' BEYOND THE RADIUS OR AS DIRECTED BY THE ENGINEER.
6. LANE TIES MAY BE OMITTED, AS DIRECTED BY THE ENGINEER IF THE EXISTING PAVEMENT HAS DETERIORATED TO THE POINT WHERE THE LANE TIES CANNOT BE PLACED.
7. LANE TIES FOR THE CURB & GUTTER SHALL BE SPACED @ 4' - 6<sup>3</sup>/<sub>4</sub>" AS SHOWN ON STANDARD PLAN II-41 SERIES.

UTILITIES - PERMITS SECTION  
REAL ESTATE DIVISION



PERMIT NO. \_\_\_\_\_  
 TRUNKLINE \_\_\_\_\_  
 NAME OF PERMIT \_\_\_\_\_  
 APPLICANT \_\_\_\_\_

PERMIT ATTACHMENT FOR  
COMMERCIAL DRIVEWAY  
CURBED TRUNKLINE

04-09-01  
PLAN DATE

PA-06

SHEET  
02 OF 02