

1/2" DIAMETER HOT ROLLED BAR

NOTE:
FASTEN THE WELDED 1/2" DIAMETER HOT-ROLLED BAR AND THE WIRE ROPE TO THE LINE POSTS THAT ARE SPECIFIED ON STANDARD PLAN R-98-SERIES.

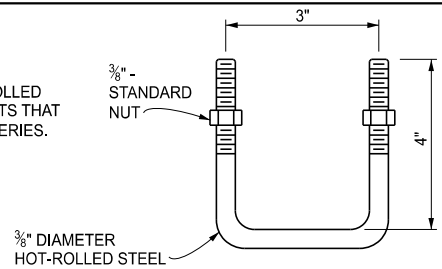

U-BOLT WITH NUTS

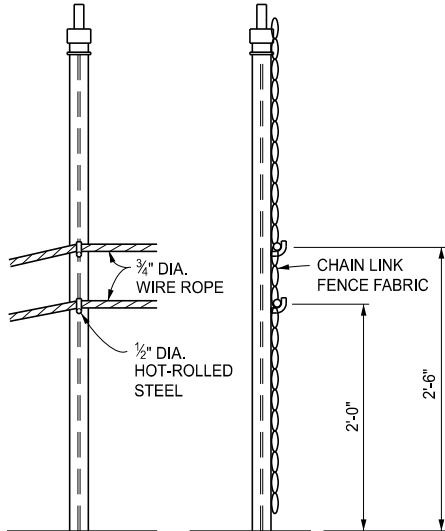

1st POST FROM ANCHOR

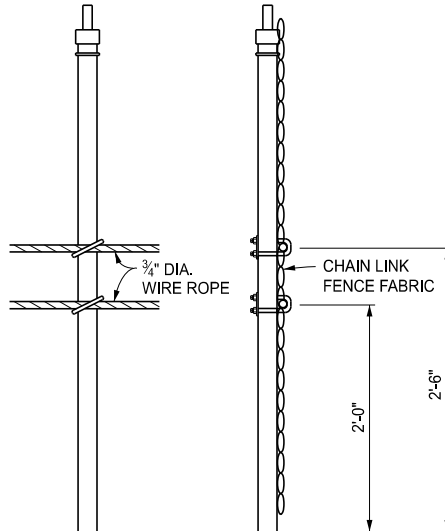

WIRE ROPE INSTALLED TO LINE POST WITH U-BOLTS

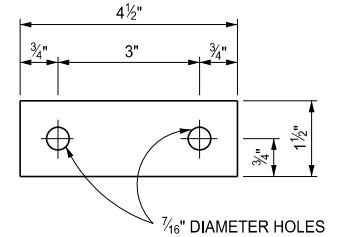

U-BOLT WASHER
1/4" THICK HOT-ROLLED STEEL

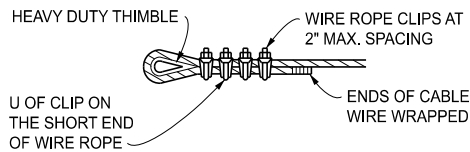

WIRE ROPE LOOP ENDING

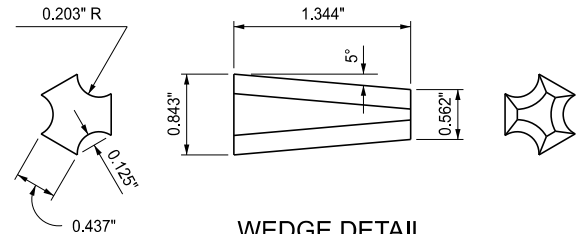

WEDGE DETAIL

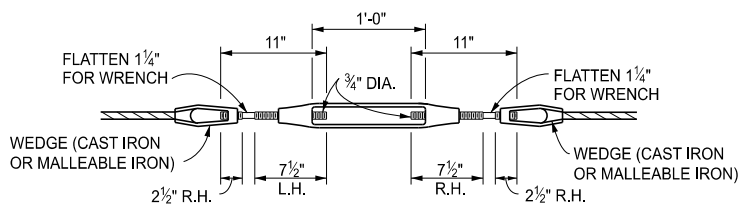

TURNBUCKLE WIRE ROPE ASSEMBLY

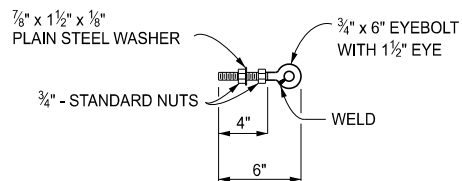

WELDED EYE-BOLT WITH NUTS & WASHER

NOTES:

INSTALL CHAIN LINK FENCE WITH WIRE ROPE ACCORDING TO THIS PLAN AND STANDARD PLAN R-98-SERIES. ANCHOR THE WIRE ROPE ACCORDING TO THIS PLAN AND INSTALL ON STANDARD FENCE POSTS FOR CHAIN LINK FENCE WITH CHAIN LINK FABRIC PLACED ON THE INSIDE OF WIRE ROPE. THE POST NEXT TO THE ANCHORAGE REQUIRES SPECIAL FABRICATION (SEE DETAIL). ALTERNATE DESIGNS MAY BE SUBMITTED TO THE ENGINEER FOR CONSIDERATION AND APPROVAL.

ENSURE ALL POSTS, WIRE ROPES, AND FITTINGS ARE GALVANIZED ACCORDING TO THE STANDARD SPECIFICATIONS FOR CONSTRUCTION.

ENSURE ALL WELDING IS ACCORDING TO THE STANDARD SPECIFICATIONS FOR CONSTRUCTION. USE TURNBUCKLES OF THE OPEN TYPE WHICH EACH PROVIDE A MINIMUM TAKEUP OF 1'-0".

PROVIDE ANCHORAGE ON EACH END OF CABLES WITH ONE TURNBUCKLE FOR EACH 500' RUN OF WIRE ROPE. ENSURE THE MAXIMUM DISTANCE BETWEEN ANCHORAGES IS 1000'. WHEN PLACING WIRE ROPE IN EXISTING FENCE, THE CONCRETE ANCHORS MAY BE PLACED 2'-0" BEYOND THE 10'-0" TYPICAL POST SPACING, LEAVING THE EXISTING POST IN PLACE.

STRETCH TENSION WIRE AND WIRE ROPES TAUT.

ENSURE A KNUCKLED FINISH ON THE TOP AND BOTTOM SELVAGES OF THE FENCE FABRIC.



DEPARTMENT DIRECTOR
BRADLEY C. WIEFERICH, PE

SPECIAL DETAIL FOR CHAIN LINK FENCE WITH WIRE ROPE

(SPECIAL DETAIL)
FHWA APPROVAL

03/17/2026
PLAN DATE

SPECIAL DETAIL 99

SHEET
2 OF 2