

ANCHOR BOLT ASSEMBLY DIMENSIONS								
LIGHT STANDARD MOUNTING HEIGHT	BOLT CIRCLE "A"	"B"	ANCHOR BOLT DIAMETER "F"	"H"	"J"	STUD PROJECTION "K"	STUD LENGTH "L"	"M"
30' *	1'-3" (A)	10 ⁵ / ₈ " (A)	1 ¹ / ₂ "	1'-9 ³ / ₄ "	2 ³ / ₈ "	5 ¹ / ₂ "	7 ¹ / ₄ "	1'-3 ³ / ₈ " (A)
	1'-0" (S)	8 ¹ / ₂ " (S)						1'-1 ¹ / ₄ " (S)
30' **	1'-3" (A)	10 ⁵ / ₈ " (A)	1 ¹ / ₂ "	1'-10 ¹ / ₂ "	2 ³ / ₈ "	5 ¹ / ₂ "	8"	1'-3 ³ / ₈ " (A)
	1'-0" (S)	8 ¹ / ₂ " (S)						1'-1 ¹ / ₄ " (S)
40' **	1'-4" (A)	11 ³ / ₈ " (A)	1 ³ / ₄ "	1'-10 ¹ / ₂ "	2 ⁷ / ₈ "	5 ¹ / ₂ "	8"	1'-5 ¹ / ₈ " (A)
	1'-3" (S)	10 ⁵ / ₈ " (S)						1'-4 ³ / ₈ " (S)
45' **	1'-5" (A)	1'-0" (A)	1 ³ / ₄ "	1'-10 ¹ / ₂ "	2 ⁷ / ₈ "	5 ¹ / ₂ "	8"	1'-5 ³ / ₄ " (A)
	1'-6" (S)	1'-0 ³ / ₄ " (S)						1'-6 ¹ / ₂ " (S)

* UP TO 15' SINGLE OR DOUBLE BRACKET ARM

** UP TO 17' SINGLE OR DOUBLE BRACKET ARM

ANCHOR BOLTS (4 REQUIRED):

"F" DIA. x 1'-2" THREADED ROD AND "F" DIA. x "L" STUD WITH 4 NUTS, 4 WASHERS, AND ONE COUPLING.

(A) = DIMENSION CORRESPONDS TO ALUMINUM

(S) = DIMENSION CORRESPONDS TO STEEL

SEE DETAIL B

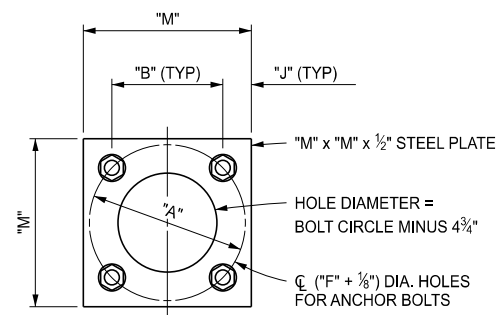
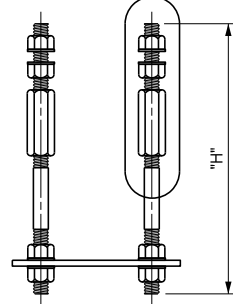

LIGHT STANDARD ANCHOR BOLT ASSEMBLY

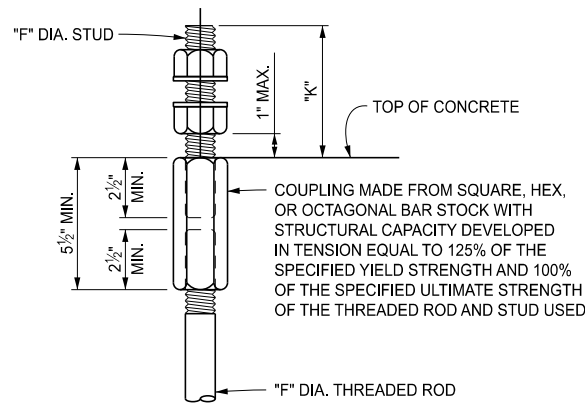

DETAIL B

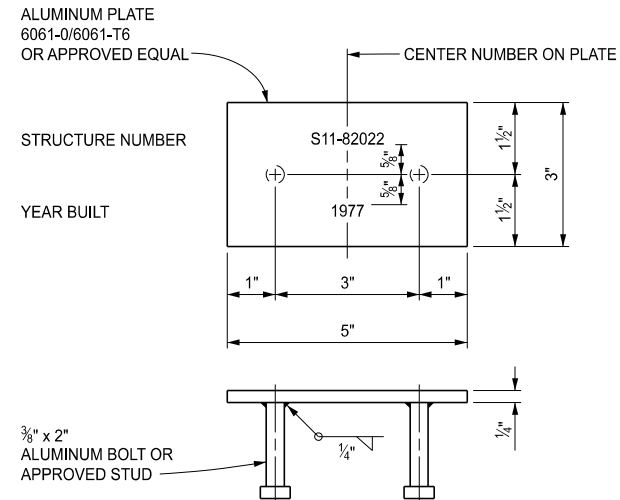

NAME PLATE

NOTES:

DIE STAMP - 1/4" MINIMUM

LETTERS AND NUMBERS SHALL BE 1/4" MINIMUM OR 3/8" MAXIMUM HEIGHT.

DATE SHALL BE YEAR THAT SUPERSTRUCTURE WAS COMPLETED.

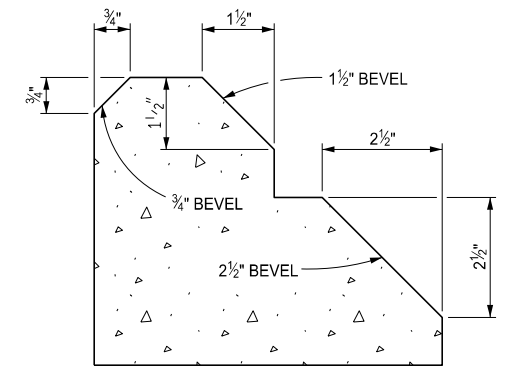

BEVEL DETAILS

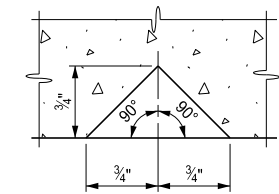

DOUBLE 3/4" Δ MOLDING

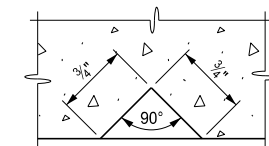

3/4" Δ MOLDING

MOLDING DETAILS

NOTES:

DETAILS SHOWN ARE ACCORDING TO THE AASHTO SPECIFICATIONS.

LIGHT STANDARD ANCHOR BOLT ASSEMBLY STEEL PLATE SHALL BE ASTM A36.

ALL STEEL SHALL BE HOT-DIP GALVANIZED ACCORDING TO THE STANDARD SPECIFICATIONS FOR CONSTRUCTION.

ANCHOR BOLTS, WASHERS, COUPLINGS AND NUTS FOR LIGHT STANDARDS SHALL BE ACCORDING TO THE STANDARD SPECIFICATIONS FOR CONSTRUCTION.

THE COUPLING SHALL BE RETAPPED AFTER GALVANIZING IN THE SAME MANNER AS SPECIFIED FOR NUTS.

ALUMINUM PLATE SHALL MEET THE REQUIREMENTS OF ASTM B209.

ALUMINUM BOLT SHALL MEET THE REQUIREMENTS OF ASTM F468.

INTERNAL DAMPENER FOR LIGHT STANDARDS SHALL BE INCLUDED AS RECOMMENDED BY THE MANUFACTURER.

APPROVED BY: _____
DIRECTOR, BUREAU OF BRIDGES AND STRUCTURES

APPROVED BY: _____
DIRECTOR, BUREAU OF FIELD SERVICES

APPROVED BY: _____
DIRECTOR, BUREAU OF DEVELOPMENT



DEPARTMENT DIRECTOR
BRADLEY C. WIEFERICH, PE

STANDARD PLAN FOR
MOLDING, BEVEL, LIGHT STD. ANCHOR BOLT ASSEMBLY
AND NAME PLATE DETAILS

(SPECIAL DETAIL)
FHWA APPROVAL

12/08/2023
PLAN DATE

B-103-F

SHEET
1 OF 2



DEPARTMENT DIRECTOR
BRADLEY C. WIEFERICH, PE

STANDARD PLAN FOR
MOLDING, BEVEL, LIGHT STD. ANCHOR BOLT ASSEMBLY
AND NAME PLATE DETAILS

(SPECIAL DETAIL)
FHWA APPROVAL

12/08/2023
PLAN DATE

B-103-F

SHEET
2 OF 2

SECT