

# SLOPE PAVING, CONC

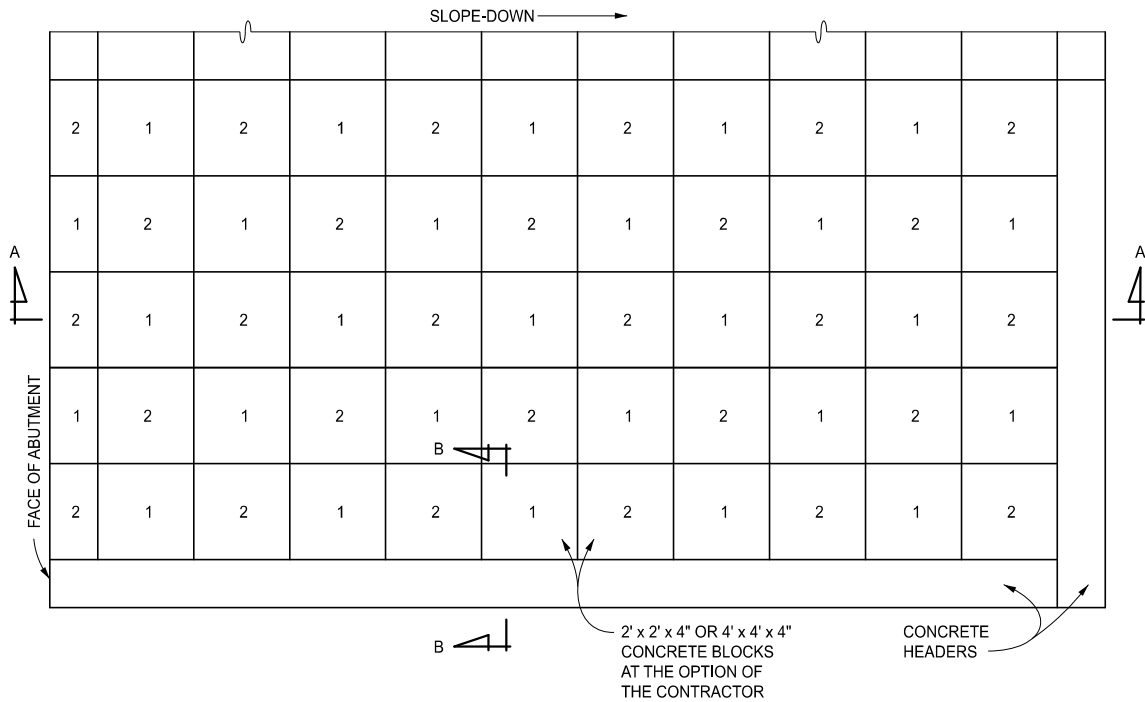

PLAN

APPROVED BY: \_\_\_\_\_  
DIRECTOR, BUREAU OF BRIDGES AND STRUCTURES

APPROVED BY: \_\_\_\_\_  
DIRECTOR, BUREAU OF FIELD SERVICES

APPROVED BY: \_\_\_\_\_  
DIRECTOR, BUREAU OF DEVELOPMENT



DEPARTMENT DIRECTOR  
BRADLEY C. WIEFERICH, PE

STANDARD PLAN FOR  
STANDARD SLOPE PAVING DETAILS

(SPECIAL DETAIL) 09/18/2023  
FHWA APPROVAL PLAN DATE

B-102-D

SHEET  
1 OF 4

# SLOPE PAVING, CONC

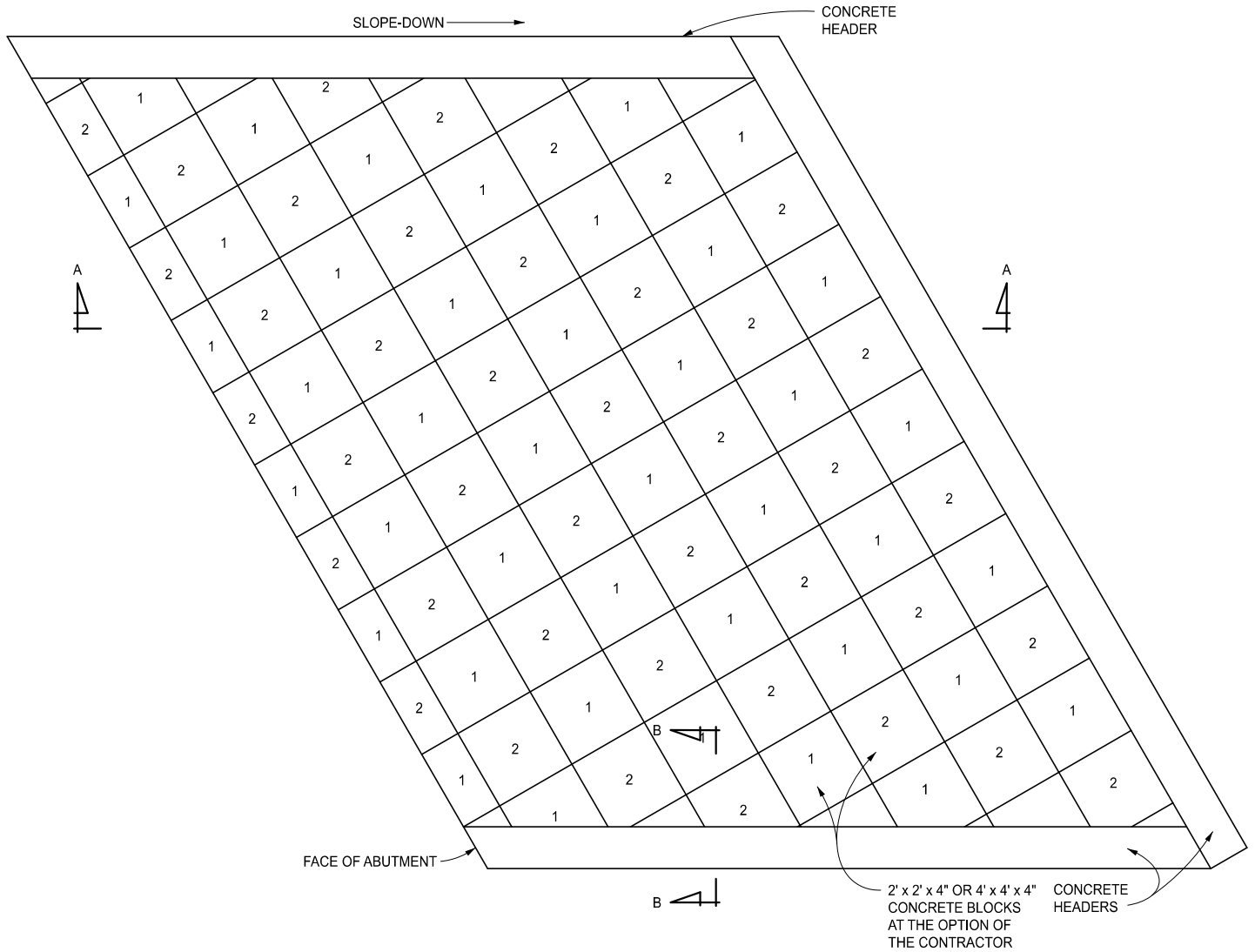

**PLAN AT SKEW**  
(APPROXIMATELY 15 DEGREES OR MORE)

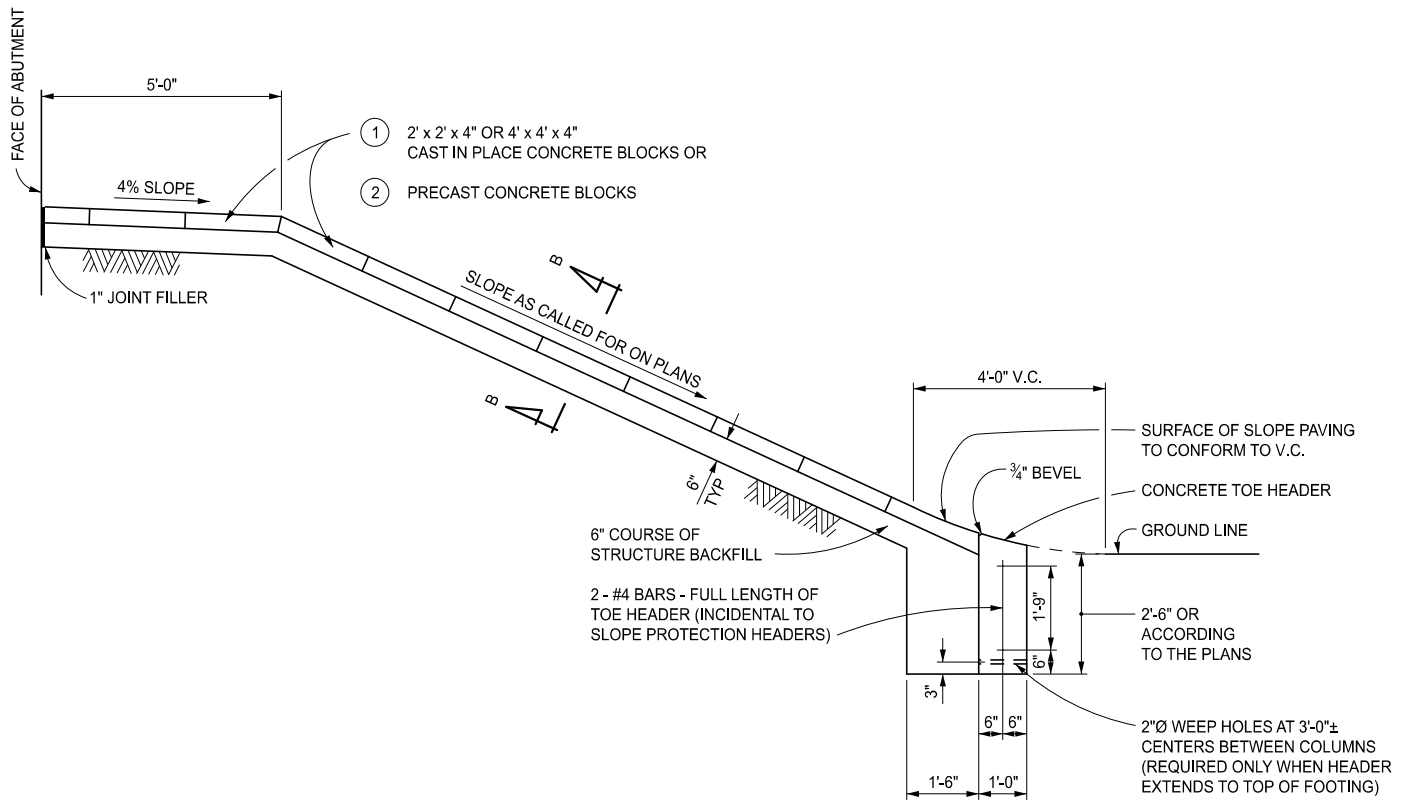

SECTION A-A

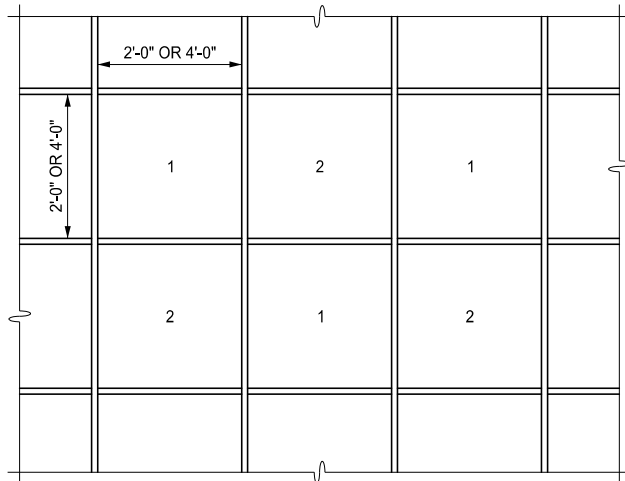

**POUR SEQUENCE**

CAST POURS NUMBER 1. REMOVE FORMS. CAST POURS NUMBER 2. IT IS PERMISSIBLE TO POUR THE SLOPE PAVING BLOCKS USING ONE OF THE FOLLOWING ALTERNATIVES.

**ALTERNATE POUR SEQUENCES**

- OPTION 1: POUR BLOCKS IN ROWS OR STRIPS USING 1" TROWELED JOINTS FOLLOWED BY 3" DEEP SAW CUT JOINTS WITHIN 48 HOURS OF CASTING.
- OPTION 2: POUR BLOCKS IN ROWS OR STRIPS USING FULL DEPTH 1/8" THICK HOT DIPPED GALVANIZED METAL DIVIDERS.

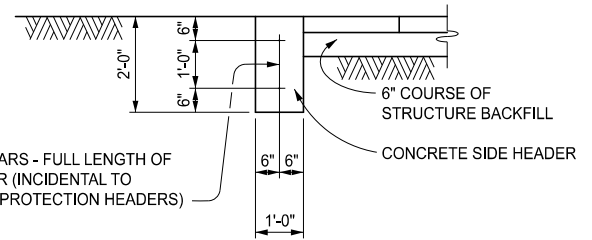

SECTION B-B

ESTIMATED CONCRETE QUANTITIES	
SLOPE PAVING, CONC	0.01 cyd / sft
SIDE HEADER, CONC	0.075 cyd / ft
TOE HEADER, CONC	0.103 cyd / ft

  
 Michigan Department of Transportation  
 DEPARTMENT DIRECTOR  
 BRADLEY C. WIEFERICH, PE

STANDARD PLAN FOR  
STANDARD SLOPE PAVING DETAILS

(SPECIAL DETAIL)	09/18/2023	<b>B-102-D</b>	SHEET 3 OF 4
FHWA APPROVAL	PLAN DATE		

# SLOPE PAVING, PRECAST CONC

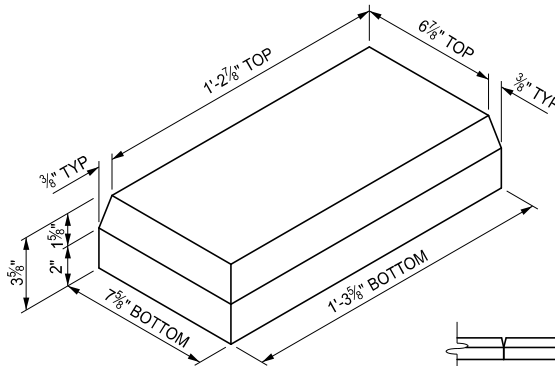
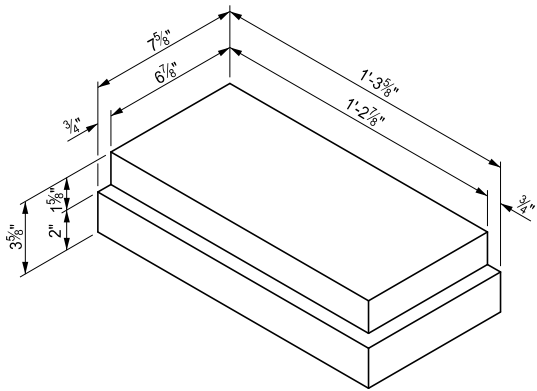
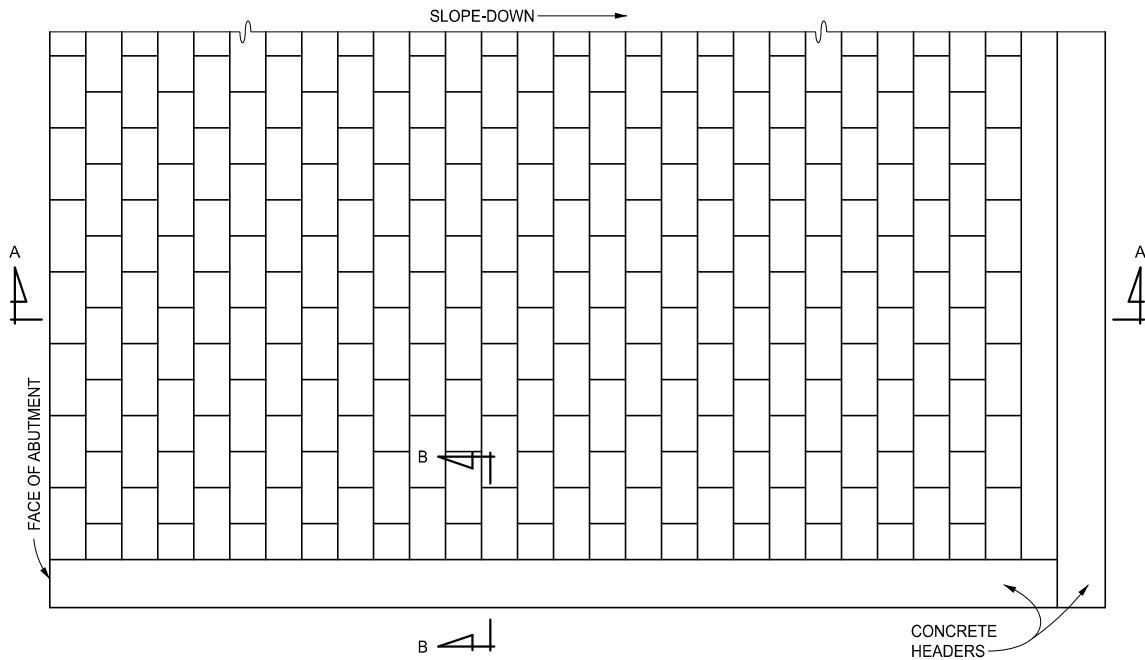

**BASIC BLOCKS**  
(RECTANGULAR OR V-JOINT AT OPTION OF MANUFACTURER)

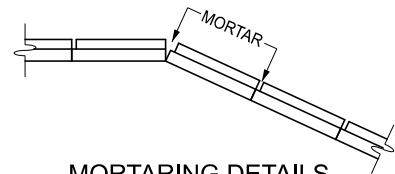
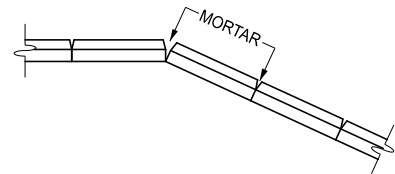

**MORTARING DETAILS**  
(MORTAR JOINTS AFTER BLOCKS ARE IN PLACE)

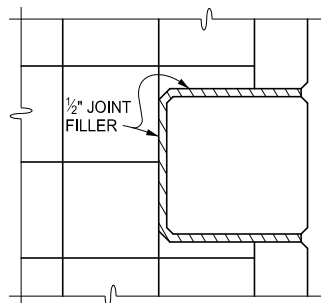
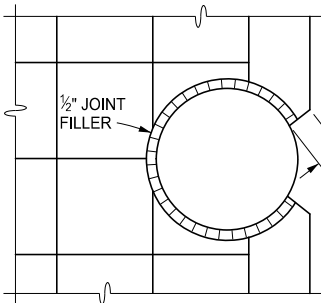

**AT ROUND COLUMNS**      **AT SQUARE COLUMNS**  
**DETAILS OF SLOPE PAVING AT PIER COLUMNS**

**NOTES:**

1/2" JOINT FILLER SHALL BE PLACED BETWEEN THE PIER COLUMNS OR PIER WALLS AND THE SLOPE PAVING. THE JOINT FILLER SHALL ALSO BE PLACED BETWEEN THE HEADER AND PIER COLUMNS. THE JOINT FILLER SHALL BE THE FULL DEPTH OF SLOPE PAVEMENT OR HEADER.

A VARIATION OF 1/8" PLUS OR MINUS IN THE DIMENSIONS FOR PRECAST CONCRETE BLOCKS WILL BE ALLOWED.

VARIATIONS IN JOINT DETAILS FOR SLOPE PAVING, PRECAST CONCRETE WILL BE ACCEPTABLE SUBJECT TO APPROVAL OF THE ENGINEER.



DEPARTMENT DIRECTOR  
BRADLEY C. WIEFERICH, PE

STANDARD PLAN FOR  
**STANDARD SLOPE PAVING DETAILS**

(SPECIAL DETAIL)  
FHWA APPROVAL

09/18/2023  
PLAN DATE

**B-102-D**

SHEET  
4 OF 4