

KEY

- CHANNELIZING DEVICES
- ← TRAFFIC FLOW
- ⊗ BALLOON OR DIFFUSED LIGHT

STANDARD NOTES

(SEE 102-GEN-NOTES)

GENERAL: G1, G2, G3, G5
SIGNING: S1

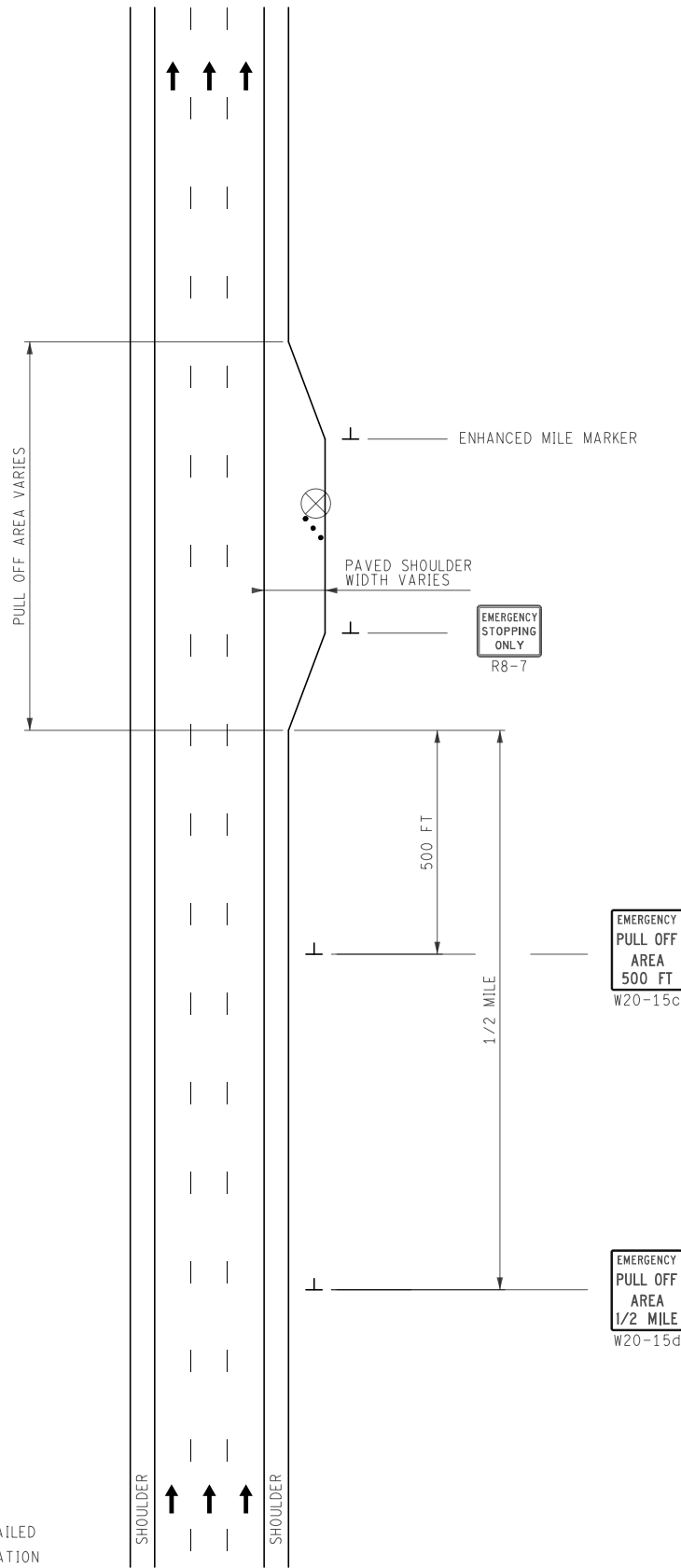

SEE PROJECT PLANS FOR DETAILED DIMENSIONS, LAYOUT AND LOCATION OF EMERGENCY PULL OFF AREAS.



NOT TO SCALE

MAINTAINING TRAFFIC TYPICAL

NO: 380-FW-PULLOFF

EMERGENCY PULL OFF SIGNING ON A FREEWAY OR DIVIDED ROADWAY

DATE: MAY 2022
SHEET:

FILE: 380-PULLOFF-FW.dgn

1 OF 1