

KEY



VEHICLE FROM WHICH WORK IS BEING PERFORMED



TRAFFIC FLOW

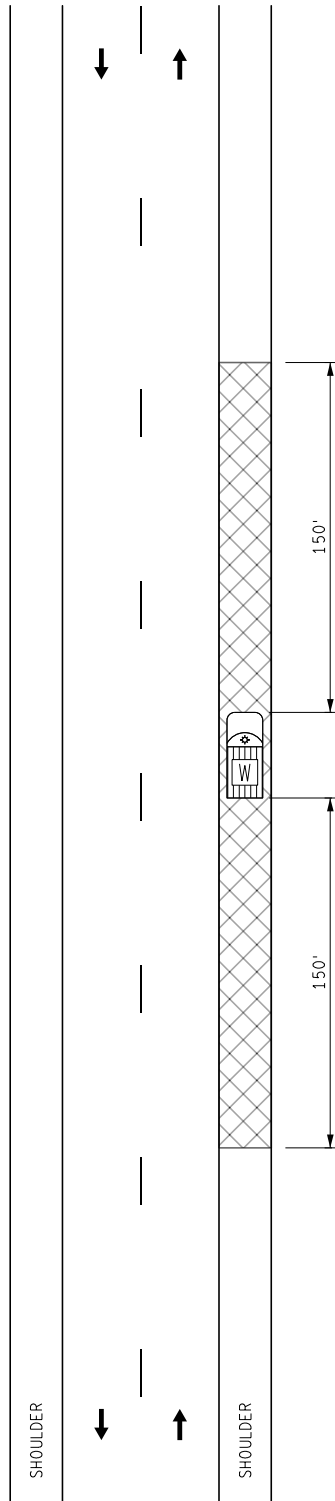

STANDARD NOTES

(SEE 102-GEN-NOTES)

GENERAL: G1, G2, G3, G4

SIGNING: S1

MAINT & SURV: MS2, MS3, MS4

NOTES

AT A MINIMUM, MAINTAINING TRAFFIC SHALL CONSIST OF AN APPROPRIATELY MARKED VEHICLE WITH A ROTATING BEACON. NO SIGNS OR CHANNELIZING DEVICES ARE REQUIRED.

THE FOLLOWING FACTORS SHOULD BE CONSIDERED IN DETERMINING THE NEED FOR ADDITIONAL ADVANCE WARNING:

1. TRAFFIC VOLUME
2. POSTED AND OPERATING SPEED LIMITS
3. HORIZONTAL AND VERTICAL ALIGNMENTS
4. URBAN OR RURAL SITE
5. WORK TYPE
6. AVAILABLE SHOULDER WIDTH

NOT TO SCALE

|  |   |                     |   |  |
|--|---|---------------------|---|--|
|  | MAINTENANCE<br>MAINTAINING TRAFFIC<br>TYPICAL | DURATION:<br>MOBILE | SHOULDERS WORK WITH<br>TRAFFIC VOLUMES LESS THAN 10,000 ADT<br>AND ADEQUATE SIGHT DISTANCES | DATE:<br>MAY 2021                          |
|  | FILE: 4400-M-SHL-MOB.dgn                      |                     |   | NO: 4400-M-NFW-SHL-MOB<br>SHEET:<br>1 OF 1 |