

KEY

- CHANNELIZING DEVICES
- ⚡ LIGHTED ARROW PANEL
- ← TRAFFIC FLOW

NOTES

1. IF THE WORK SPACE IS LESS THAN $\frac{1}{2}$ MILE FROM THE BEGINNING OF THE PASSING LANE, THE PASSING LANE SHOULD BE CLOSED FROM THE BEGINNING.
2. IF THERE IS LESS THAN 1000 FEET OF PASSING LANE REMAINING BEYOND THE WORK SPACE, THE PASSING LANE SHOULD BE CLOSED TO THE END.
3. COVER CONFLICTING PERMANENT ADVANCED PASSING LANE SIGNS PRIOR TO THE WORK SPACE.

STANDARD NOTES

(SEE 102-GEN-NOTES)

GENERAL: G1, G2, G3, G4
 SIGNING: S1
 DEVICES: TCD1, TCD2, TCD6
 MAINT & SURV: MS2, MS3, MS4, MS6

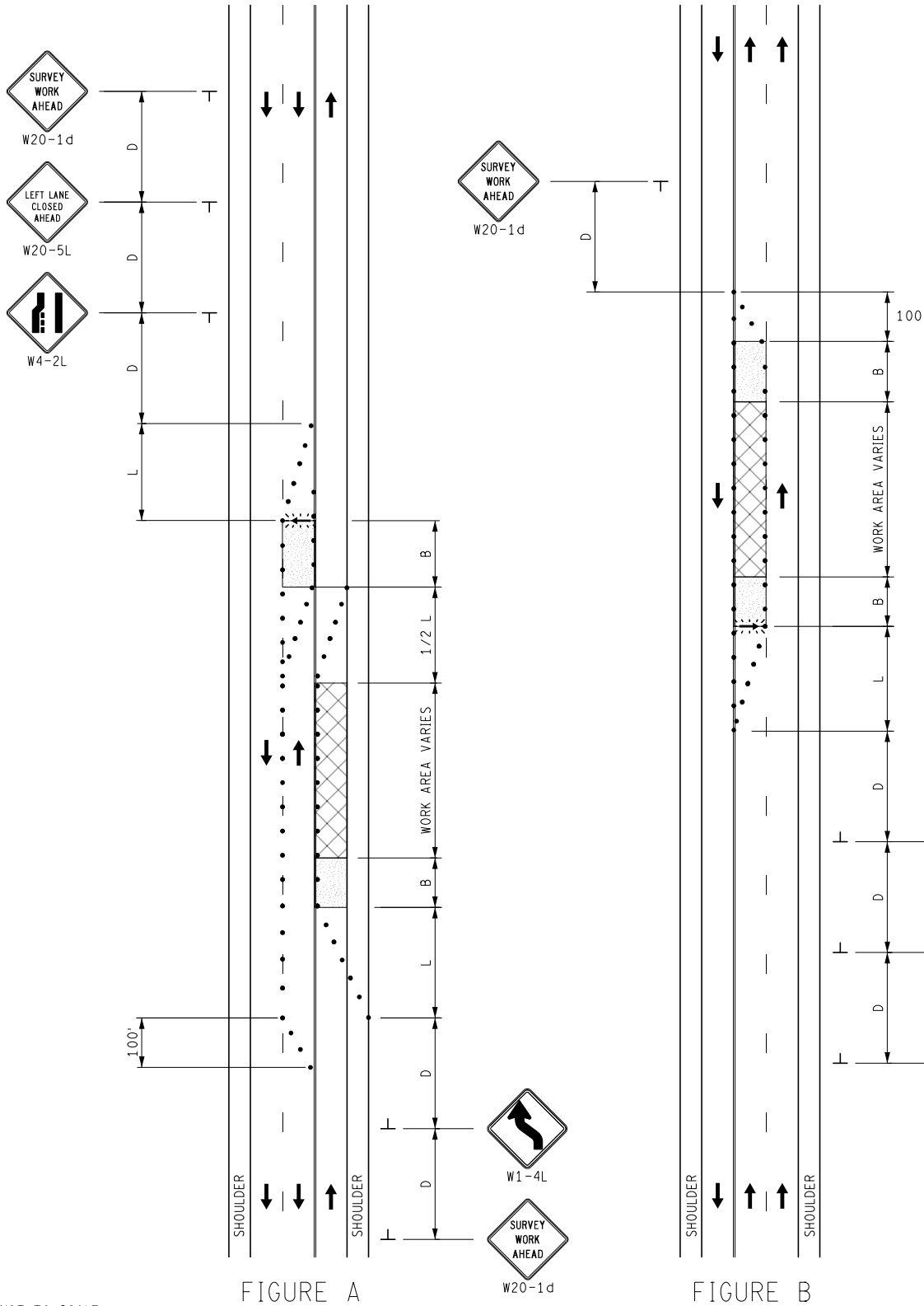

FIGURE A

FIGURE B

NOT TO SCALE

	SURVEYING MAINTAINING TRAFFIC TYPICAL	DURATION: SHORT-TERM STATIONARY	LANE CLOSURE ON A 3-LANE, TWO-WAY ROADWAY	DATE: MAY 2021
				NO: 5181-S-NFW-1LC
FILE: 5181-S-NFW-1LC.dgn				SHEET: 1 OF 1