

\* SIGN HEIGHT (MAX. 4 FT)  
 \*\* WIDTH OF SIGN (MAX. 3 FT)  
 \*\*\* SPACING TO MATCH SIGN HOLE PLACEMENT

9/16" DIA HOLE FOR 1/2" ANCHOR BOLT WITH MINIMUM EMBEDMENT

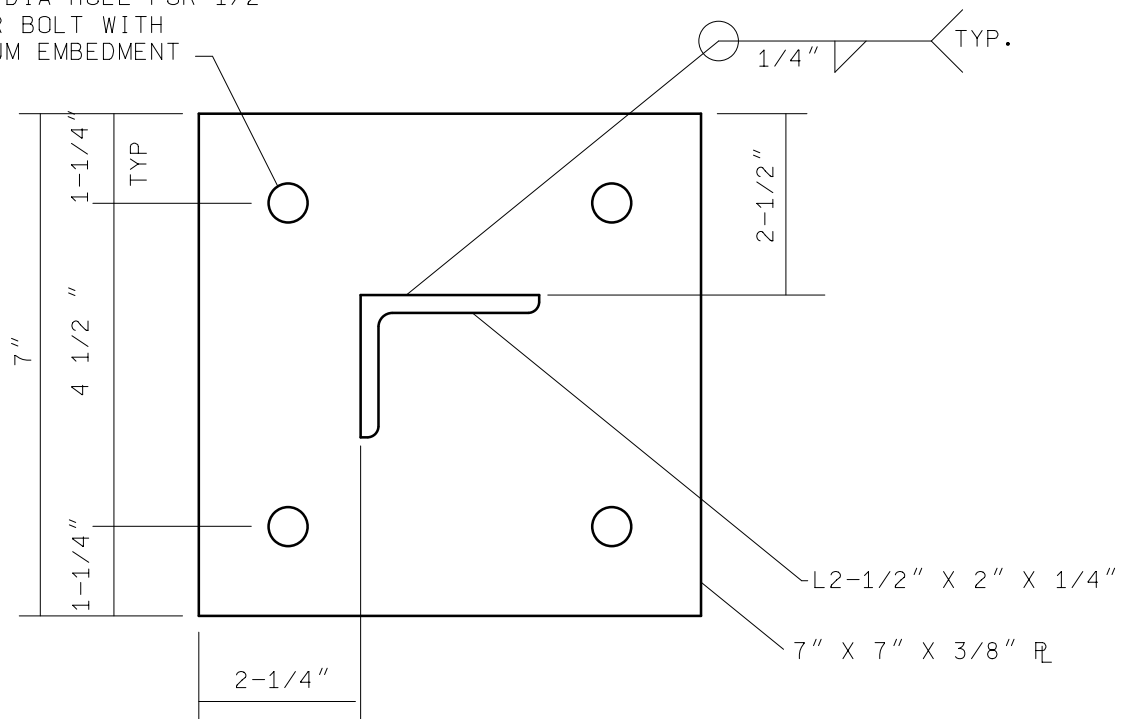

SECTION A-A

NOTES:

1. ANCHOR BOLTS SHALL BE EPOXIED INTO DRILLED HOLES.
2. MAXIMUM SIGN SIZE 12 SQUARE FEET.
3. ALL STRUCTURAL STEEL BOLTS, WELDING & GALVANIZING SHALL BE PER MDOT STANDARD SPECIFICATIONS FOR CONSTRUCTION.
4. ALL STEEL COMPONENTS SHALL BE HOT DIPPED GALVANIZED AFTER FABRICATION AND WELDING.
5. ANCHOR BOLTS SHALL BE 1/2" DIAMETER STAINLESS STEEL.



PREPARED BY  
 DESIGN DIVISION

DRAWN BY: DHD  
 CHECKED BY: AJU

DEPARTMENT DIRECTOR  
 Kirk T. Steudle

APPROVED BY: Randy U. Pittel  
 DIRECTOR, BUREAU OF FIELD SERVICES

APPROVED BY: Paul A. Van Pelt  
 DIRECTOR, BUREAU OF HIGHWAY DEVELOPMENT

MICHIGAN DEPARTMENT OF TRANSPORTATION  
 BUREAU OF HIGHWAY DEVELOPMENT STANDARD PLAN FOR

RETAINING WALL  
 CONNECTION

08/17/05  
 F.H.W.A. APPROVAL

03/01/05  
 PLAN DATE

SIGN-710-A

SHEET  
 1 OF 1