



1

6

EX 120' ROW

5

RAMP B/C/F  
NON-LEGAL ALI

2

HMA SURFACE, REM

5

NB I-75  
LEGAL ALI

12' LANE

12' LANE

12' LANE

11' SHOULDER

10'

EX POINT OF ROTATION

RATE OF SUPER

4

VARIES 0' TO 18' (1)  
RAMP LANE

VARIES 4' TO 11'  
SHOULDER

EX GUARDRAIL (SALV)

EX GROUND

EX 7" HMA PAVT  
EX AGGREGATE BASE  
EX 8.5" TO 10" HMA PAVT

EX 8" CONCRETE PAVT  
EX 4" AGGREGATE BASE  
EX 10" SUBBASE

EX 7" TO 11" HMA PAVT  
EX 8" AGGREGATE BASE 3

GRADE TO THIS LINE  
PAID FOR AS  
EXCAVATION, EARTH 2

### EXISTING NB I-75 SUPERELEVATED SECTION

8

SECTION APPLIES TO:  
NB I-75 LEGAL ALI STA 951+47 TO STA 956+07  
NB I-75 LEGAL ALI STA 964+59 TO STA 986+81

(1) APPLIES TO:  
RAMP B NON-LEGAL ALI STA 100+03 TO STA 104+23  
RAMP C NON-LEGAL ALI STA 208+67 TO STA 222+78

6

EX 110' ROW

5

HOLLY ROAD  
NON-LEGAL ALI

2

HMA SURFACE, REM

12' LANE

12' LANE

12' LANE

7' SHOULDER

VAR

1%

RATE OF SUPER

EX POINT OF ROTATION

13

RATE OF SUPER

VARIES 7' TO 8'  
SHOULDER

VAR

EX GUARDRAIL

EX GROUND

EX 5" HMA PAVT

EX 12" HMA PAVT 3  
EX 6" AGGREGATE BASE

EX 5" HMA PAVT

EX GUARDRAIL (SALV)

GRADE TO THIS LINE  
PAID FOR AS  
EXCAVATION, EARTH 2

### EXISTING HOLLY ROAD SUPERELEVATED SECTION

SECTION APPLIES TO:  
HOLLY ROAD NON-LEGAL ALI STA 201+17.28 TO STA 207+00

FINAL ROW PLAN REVISIONS		SUBMITTAL DATE:	
NO.	DATE	AUTH	DESCRIPTION

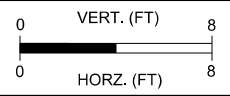

PLAN GUIDELINES  
SAMPLE PLANS  
FILE: 115832\_ExTyp\_001.dgn

DATE: 02/18/21  
DESIGN UNIT:IDS  
TSC: ENGINEERING SUPPORT

CS: 55555  
JN: 123456  
234567

TYPICAL CROSS SECTIONS  
NB I-75  
HOLLY ROAD

DRAWING SHEET  
NB I-75  
TYP 1  
SECT 1

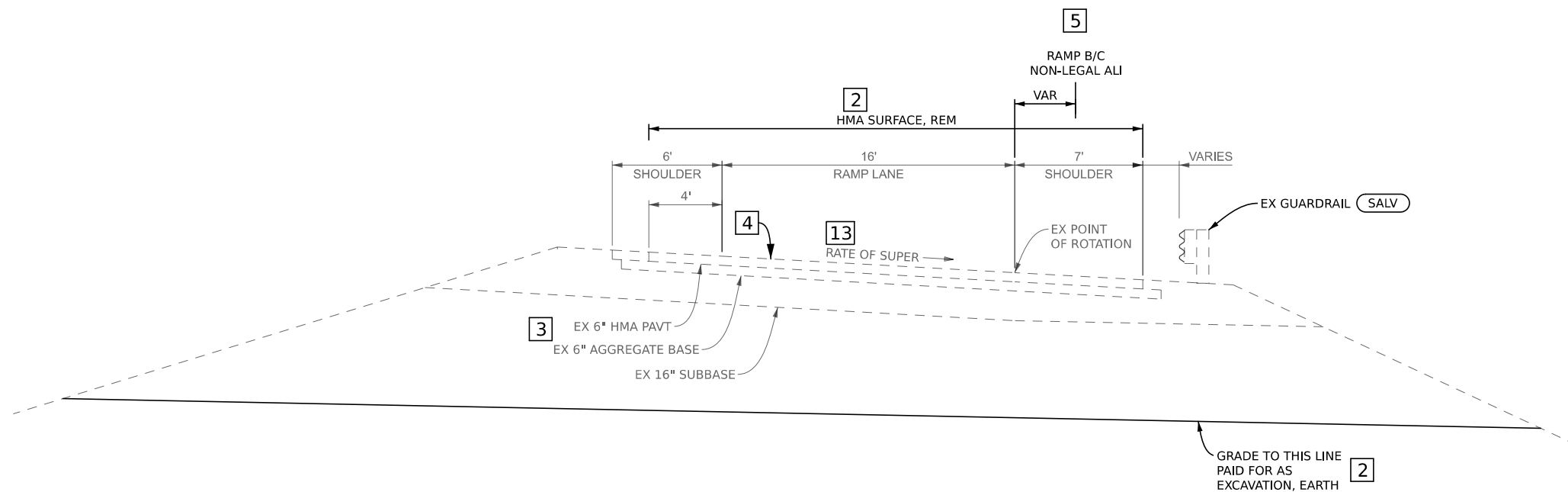

EXISTING RAMP SECTION

SECTION APPLIES TO:  
 RAMP B NON-LEGAL ALI STA 104+23 TO STA 115+51  
 RAMP C NON-LEGAL ALI STA 201+00 TO STA 208+67

8

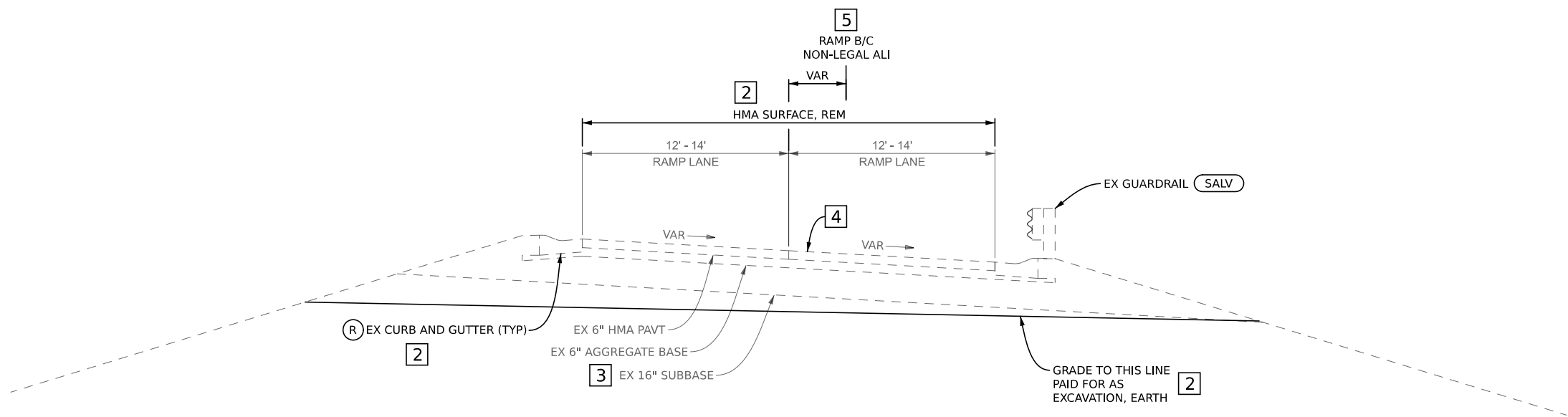

EXISTING RAMP SECTION

SECTION APPLIES TO:  
 RAMP B NON-LEGAL ALI STA 115+51 TO STA 116+45  
 RAMP C NON-LEGAL ALI STA 200+45 TO STA 201+00

8

FINAL ROW PLAN REVISIONS				SUBMITTAL DATE:			
NO.	DATE	AUTH	DESCRIPTION	NO.	DATE	AUTH	DESCRIPTION

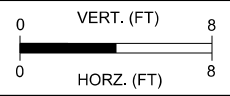

PLAN GUIDELINES  
 SAMPLE PLANS  
 FILE: 115832\_ExTyp\_002.dgn

DATE: 02/18/21  
 DESIGN UNIT:IDS  
 TSC: ENGINEERING SUPPORT

CS: 55555  
 JN: 123456  
 234567

TYPICAL CROSS SECTIONS	
RAMP B	SECT 1
RAMP C	TYP 2

DRAWING SHEET

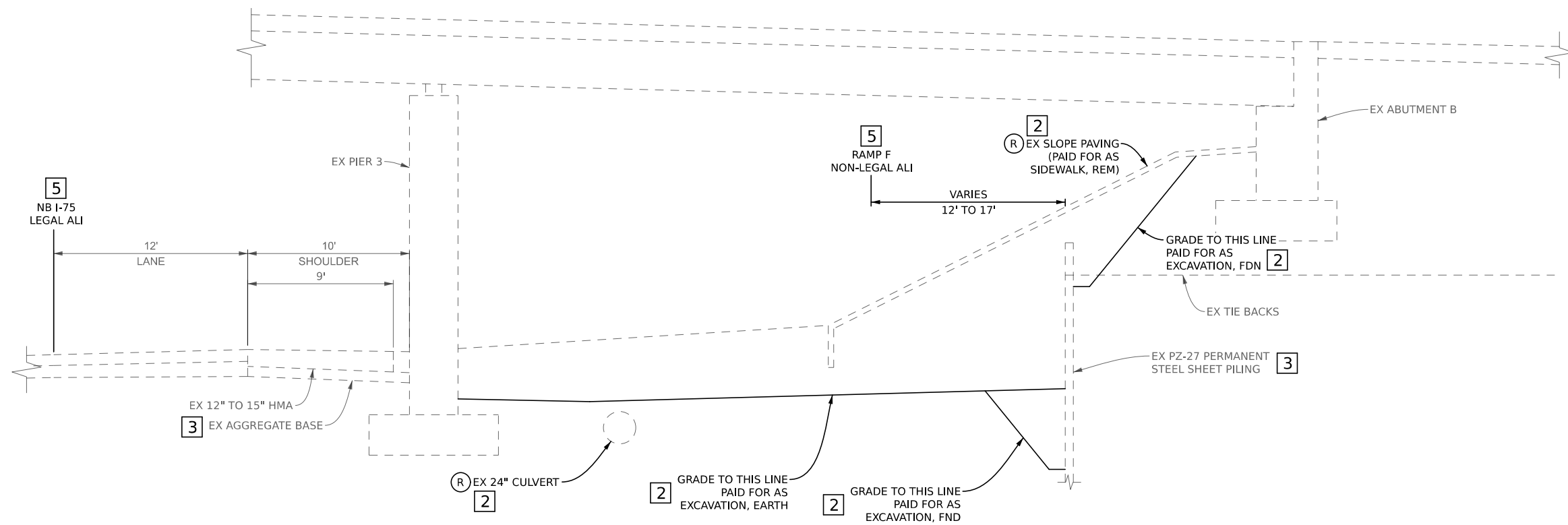

EXISTING RAMP F UNDER HOLLY ROAD SECTION

SECTION APPLIES TO:  
RAMP F NON-LEGAL ALI STA 310+34 TO STA 311+32

FINAL ROW PLAN REVISIONS				SUBMITTAL DATE:			
NO.	DATE	AUTH	DESCRIPTION	NO.	DATE	AUTH	DESCRIPTION

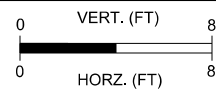

PLAN GUIDELINES	DATE: 02/18/21
SAMPLE PLANS	DESIGN UNIT:IDS
FILE: 115832_ExTyp_003.dgn	TSC: ENGINEERING SUPPORT

CS: 55555
JN: 123456
234567

TYPICAL CROSS SECTIONS
RAMP F

DRAWING SHEET
RAMP F TYP 3
SECT 1

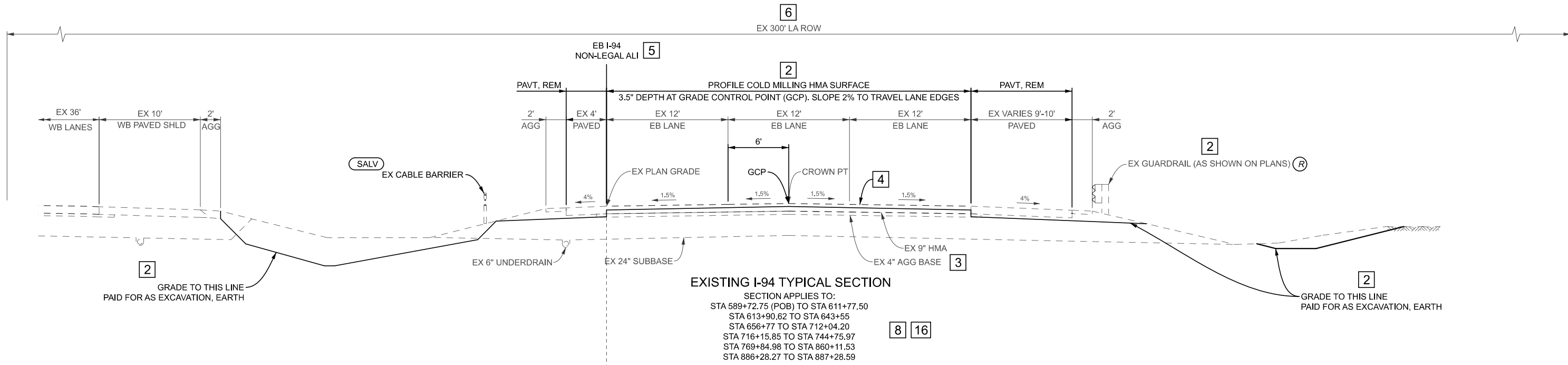

**EXISTING I-94 TYPICAL SECTION**  
 SECTION APPLIES TO:  
 STA 589+72.75 (POB) TO STA 611+77.50  
 STA 613+90.62 TO STA 643+55  
 STA 656+77 TO STA 712+04.20  
 STA 716+15.85 TO STA 744+75.97  
 STA 769+84.98 TO STA 860+11.53  
 STA 886+28.27 TO STA 887+28.59

**NOTE:**  
 GAP S13 OF 11015 STA 611+77.50 TO STA 613+90.62  
 NO WORK FROM STA 643+55 TO STA 656+77

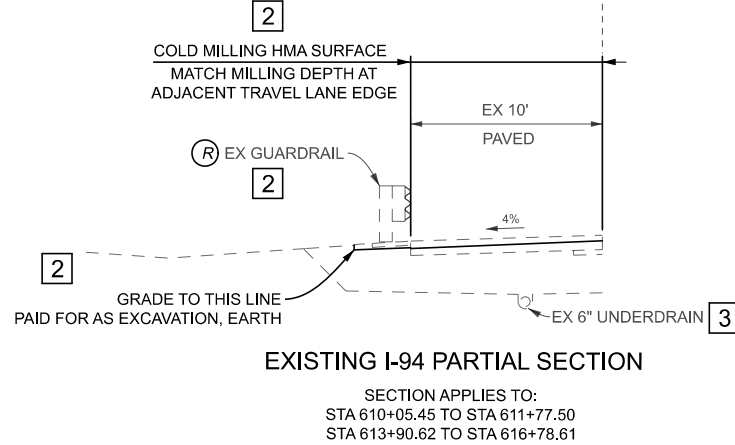

**EXISTING I-94 PARTIAL SECTION**  
 SECTION APPLIES TO:  
 STA 610+05.45 TO STA 611+77.50  
 STA 613+90.62 TO STA 616+78.61

**7**  
 STATION EQUATION: I-94 EB  
 STA 767+85.40 BK =  
 STA 767+76.98 AH  
 LINE LENGTHENS 8.42'

**7**  
 STATION EQUATION: I-94 EB  
 STA 883+69.18 BK =  
 STA 883+57.30 AH  
 LINE LENGTHENS 11.88'

FINAL ROW PLAN REVISIONS		SUBMITTAL DATE:	
NO.	DATE	AUTH	DESCRIPTION

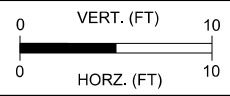

PLAN GUIDELINES  
 SAMPLE PLANS  
 FILE: 119672\_I94EB\_Typicals.dgn

DATE: 02/18/21  
 DESIGN UNIT: IDS  
 TSC: ENGINEERING SUPPORT

CS: 55555  
 JN: 123456  
 234567

TYPICAL CROSS SECTIONS  
 I-94

DRAWING SHEET  
 I-94 TYP 1  
 SECT 1

6

EX 300' LA ROW

5

12

12

10

9

8 16

7

15

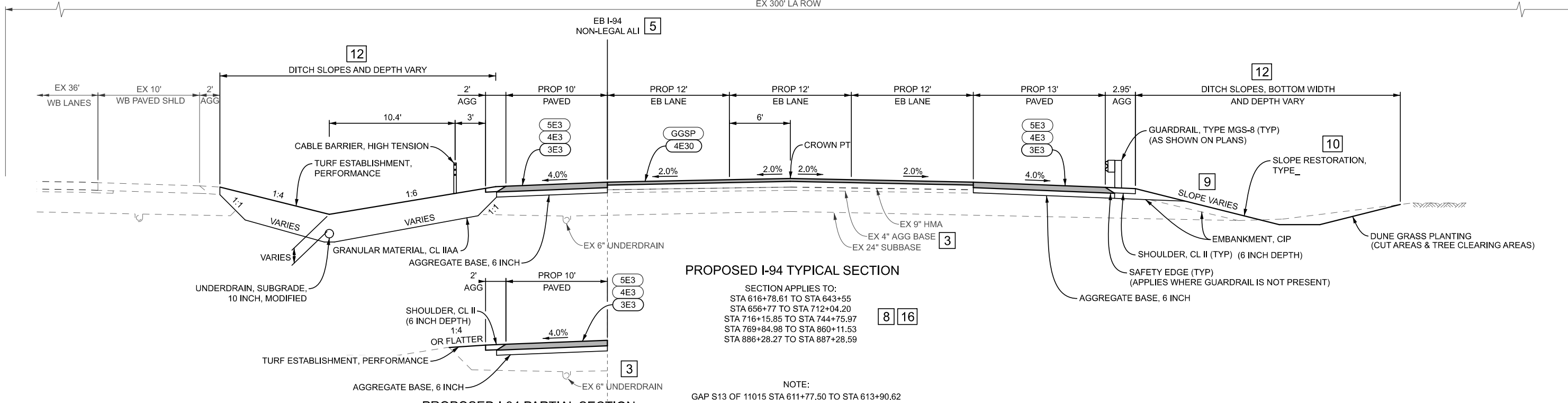

### PROPOSED I-94 TYPICAL SECTION

SECTION APPLIES TO:  
 STA 616+78.61 TO STA 643+55  
 STA 656+77 TO STA 712+04.20  
 STA 716+15.85 TO STA 744+75.97  
 STA 769+84.98 TO STA 860+11.53  
 STA 886+28.27 TO STA 887+28.59

NOTE:  
 GAP S13 OF 11015 STA 611+77.50 TO STA 613+90.62  
 NO WORK FROM STA 643+55 TO STA 656+77

### PROPOSED I-94 PARTIAL SECTION

SECTION APPLIES TO:  
 STA 589+72.75 (POB) TO STA 610+05.45

### PROPOSED I-94 PARTIAL SECTION

SECTION APPLIES TO:  
 STA 610+05.45 TO STA 611+77.50  
 STA 613+90.62 TO STA 616+78.61

#### HMA APPLICATION ESTIMATE

IDENT NO.	ITEM	RATE LBS PER SYD	PERFORMANCE GRD	REMARKS
GGSP	HMA, GAP GRADED SUPERPAVE	165	PG 70-28P	MAINLINE TOP COURSE - AWI 260
4E30	HMA, 4E30	220	PG 70-28P	MAINLINE LEVELING COURSE
WE30	HMA, 5E30	82.5-220	PG 64-22	MAINLINE WEDGING
5E3	HMA, 5E3	165	PG 64-22	MAINLINE SHLD & RAMP TOP COURSE
4E3	HMA, 4E3	220	PG 64-22	MAINLINE SHLD AND RAMP LEVELING COURSE
3E3	HMA, 3E3	330	PG 64-22	MAINLINE SHLD & RAMP BASE COURSE
WE3	HMA, 5E3	82.5-220	PG 64-22	MAINLINE SHOULDER WEDGING
HA-1	HMA APPROACH	165	PG 64-22	HMA 5E3 - GORE AND CROSSOVER TOP
HA-2	HMA APPROACH	220	PG 64-22	HMA, 4E3 - GORE AND CROSSOVER LEVELING
HA-3	HMA APPROACH	330	PG 64-22	HMA, 3E3 - GORE & CROSSOVER BASE
	* BOND COAT	0.05-0.15 GAL		

\*FOR INFORMATION ONLY

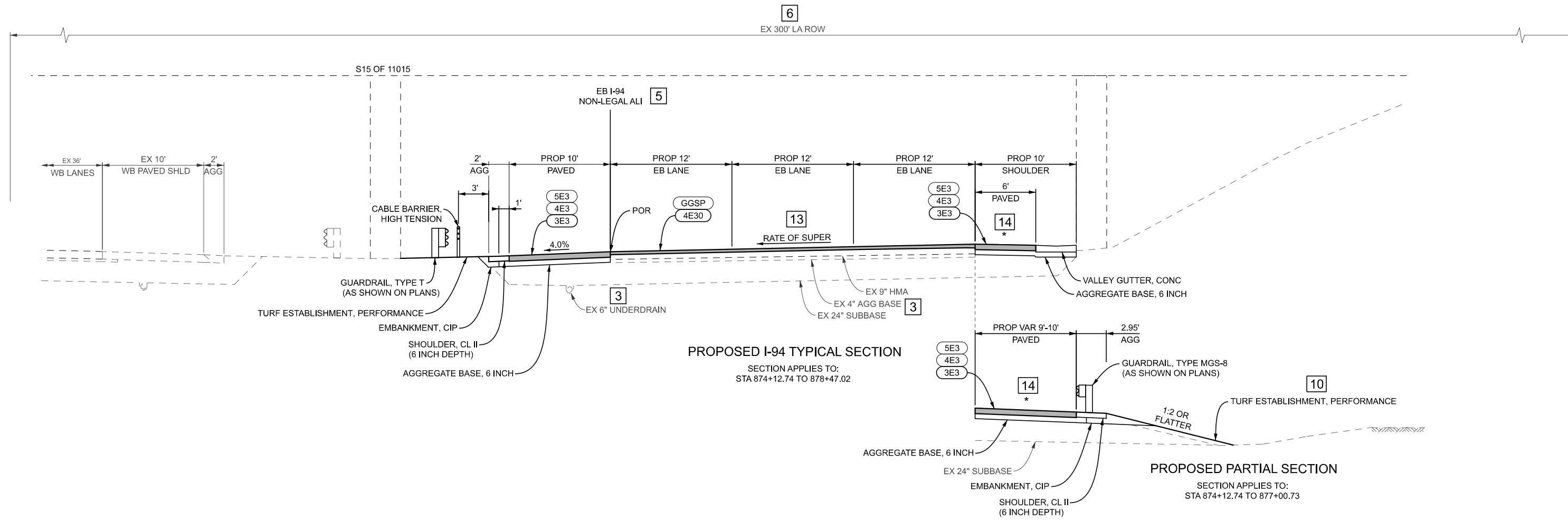

**PROPOSED I-94 TYPICAL SECTION**  
SECTION APPLIES TO:  
STA 874+12.74 TO 878+47.02

**PROPOSED PARTIAL SECTION**  
SECTION APPLIES TO:  
STA 874+12.74 TO 877+00.73

\* FOR SHOULDER SLOPES IN SUPER TRANSITION AND FULL SUPER SEE STANDARD PLAN R-107 SERIES

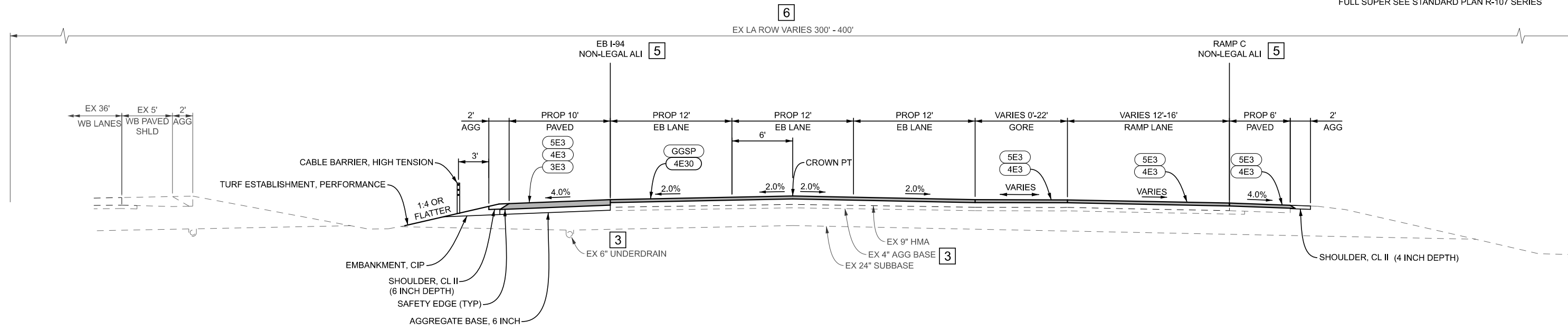

**PROPOSED I-94 TYPICAL SECTION WITH RAMP C GORE**  
SECTION APPLIES TO:  
STA 887+28.59 TO STA 890+06.07

FINAL ROW PLAN REVISIONS						SUBMITTAL DATE:													
NO.	DATE	AUTH	DESCRIPTION	NO.	DATE	AUTH	DESCRIPTION					DRAWING SHEET							
												I-94	SECT 1						
								0 VERT. (FT) 10 0 HORZ. (FT) 10		PLAN GUIDELINES SAMPLE PLANS FILE: 119672_I94EB_Typicals.dgn		DATE: 02/18/21 DESIGN UNIT:IDS TSC: ENGINEERING SUPPORT		CS: 55555 JN: 123456 234567		TYPICAL CROSS SECTIONS I-94		I-94 TYP 3	

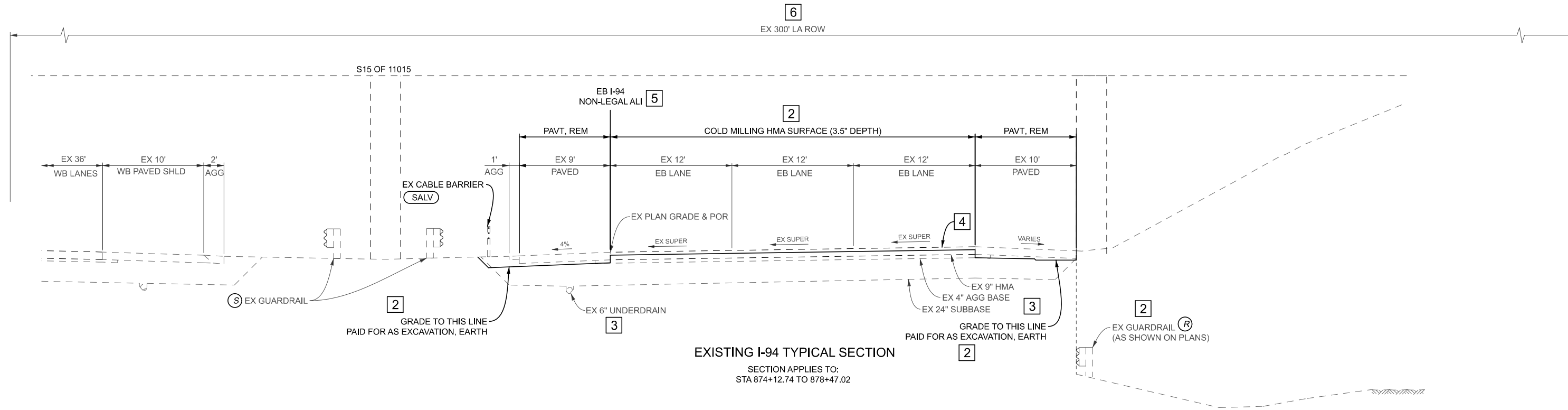

**EXISTING I-94 TYPICAL SECTION**  
SECTION APPLIES TO:  
STA 874+12.74 TO 878+47.02

**EXISTING PARTIAL SECTION**  
SECTION APPLIES TO:  
STA 874+12.74 TO 877+00.73

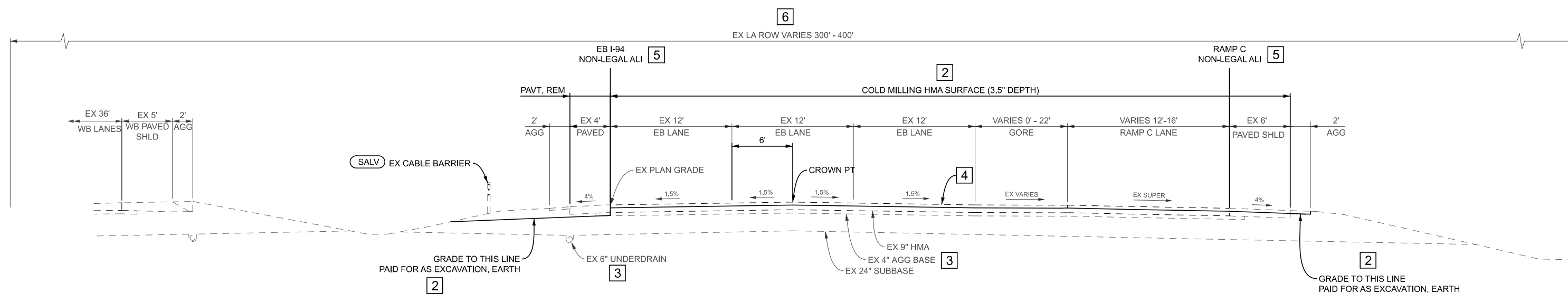

**EXISTING I-94 TYPICAL SECTION WITH RAMP C GORE**  
SECTION APPLIES TO:  
STA 887+28.59 TO STA 890+06.07

FINAL ROW PLAN REVISIONS				SUBMITTAL DATE:					0 VERT. (FT)		PLAN GUIDELINES SAMPLE PLANS FILE: 119672_I94EB_Typicals.dgn	DATE: 02/18/21		CS: 55555		TYPICAL CROSS SECTIONS		DRAWING SHEET
NO.	DATE	AUTH	DESCRIPTION	NO.	DATE	AUTH	DESCRIPTION		0			DESIGN UNIT:IDS	JN: 123456		I-94			
									0			TSC: ENGINEERING SUPPORT	234567		I-94 TYP 4			
								0					I-94 TYP 4		SECT 1			







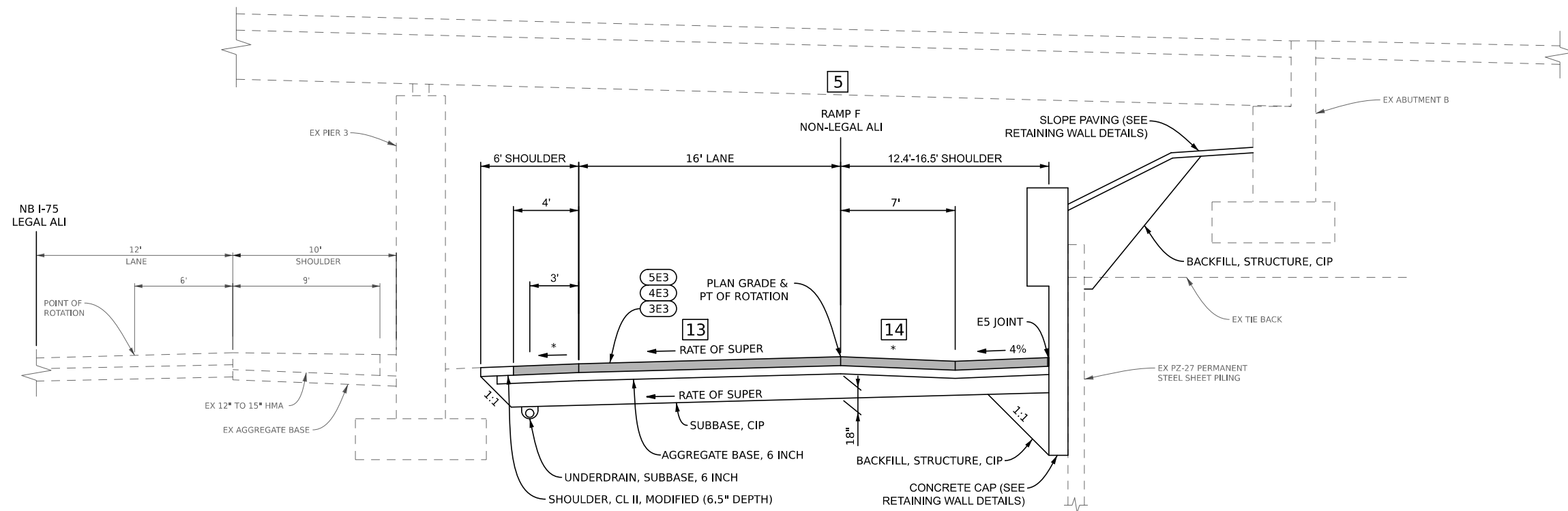

**PROPOSED RAMP SECTION UNDER HOLLY ROAD**

SECTION APPLIES TO:  
RAMP F STA 310+37 TO STA 311+24.44

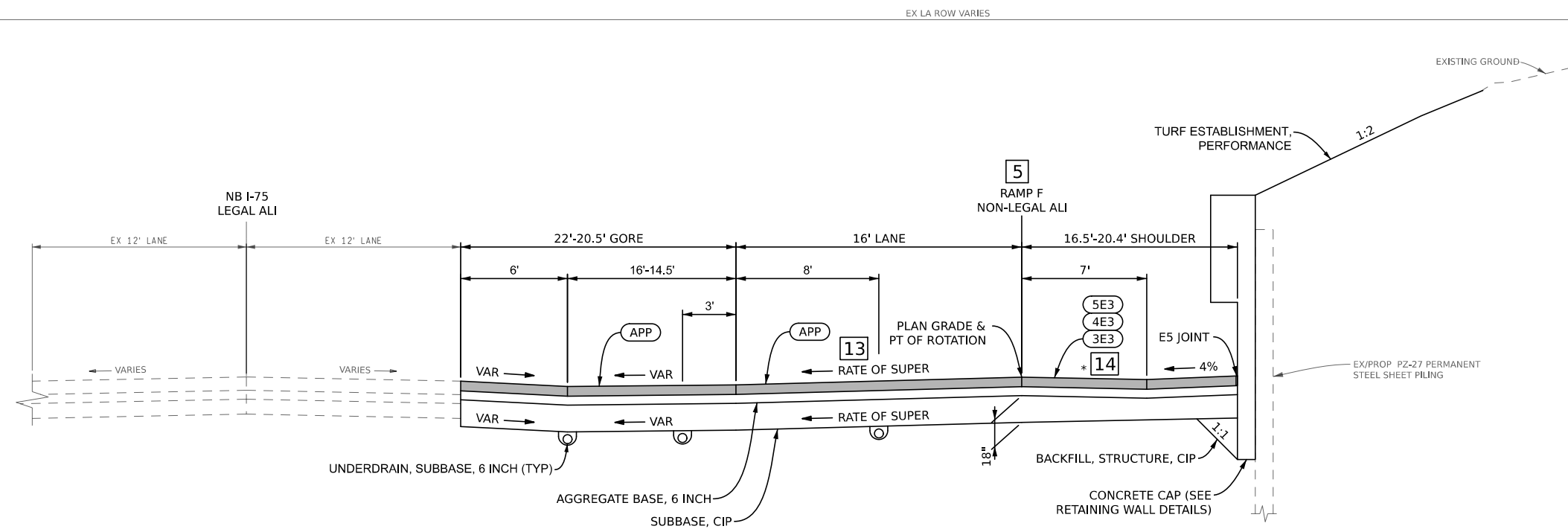

**PROPOSED RAMP AND GORE SECTION**

SECTION APPLIES TO:  
RAMP F STA 311+24.44 TO STA 312+00

**14**

\* FOR SHOULDER SLOPES IN SUPER TRANSITION AND FULL SUPER SEE STANDARD PLAN R-107 SERIES

FINAL ROW PLAN REVISIONS				SUBMITTAL DATE:			
NO.	DATE	AUTH	DESCRIPTION	NO.	DATE	AUTH	DESCRIPTION

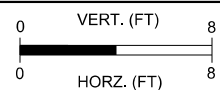

PLAN GUIDELINES  
SAMPLE PLANS  
FILE: 115832\_PrTyp\_006.dgn

DATE: 02/18/21  
DESIGN UNIT:IDS  
TSC: ENGINEERING SUPPORT

CS: 55555  
JN: 123456  
234567

TYPICAL CROSS SECTIONS  
RAMP F

DRAWING SHEET  
RAMP F TYP 6  
SECT 1