

NE-NE
SEC. 9

SE-SE
SEC. 4

T5S-R19W

SW-SW
SEC. 3

SW-NW
SEC. 3

NW-SW
SEC. 3

CURVE DATA
 $\Delta = 22^{\circ}41' L$
 $D = 5^{\circ}40'$
 $T = 202.80'$
 $L = 400.29'$
 $R = 1011.51'$
 $E =$
 $PC = 746+91.20$
 $PI = 748+94.00$
 $PT = 750+91.49 = 750+96.80$

STA EQUATION
 STA 750+91.49 BACK=
 STA 750+96.80 AHEAD
 LINE SHORTENS 22.35'.

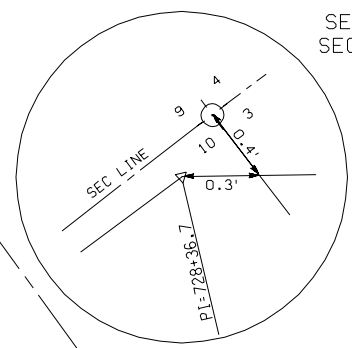

VILLAGE OF SHOREHAM

CURVE DATA

$\Delta = 35^{\circ}59' R$
 $D = 5^{\circ}40'$
 $T = 328.67'$
 $L = 634.99'$
 $R = 1011.51'$
 $E =$
 $PC = 725+08.03$
 $PI = 728+36.7$
 $PT = 731+43.02 = 731+65.37$

CURVE DATA

$\Delta = 2^{\circ}17' L$
 $D = 1^{\circ}00'$
 $T = 114.21'$
 $L = 228.33'$
 $R = 5729.65'$
 $E =$
 $PC = 757+54.79$
 $PI = 758+69.0$
 $PT = 759+83.12$

PROJ. NO. 11-28

| PARCEL | GRANTOR | INST | DATE RECORDED | LIBER-PAGE | COV |
|--------|--------------------|------|---------------|------------|-----|
| 1 | CHARLES MESCHKE | D | 7-26-29 | 33MR-255 | COV |
| 2 | RACHEL MEYER | D | 7-26-29 | 33MR-246 | COV |
| 3 | JOSEPHINE V. PEASE | D | 10-25-29 | 33MR-271 | COV |
| 7 | LEONORE G. NONNAST | D | 8-20-29 | 33MR-264 | COV |
| 8 | FLOYD B. WEAKLY | D | 7-26-29 | 33MR-262 | COV |

STA EQUATION
 STA 731+43.02 BACK=
 STA 731+65.37 AHEAD
 LINE SHORTENS 22.35'.

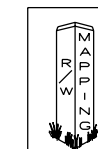

RIGHT-OF-WAY MAP

| | |
|-----------------------------|------------------------|
| DRAWN BY: DLZ | CHECKED BY: DLZ |
| LAST REVISION DATE: 1/08/01 | ROUTE: I-94BL |
| COUNTY: BERRIEN | PROJ/JOB: 11-28 |
| FILE NO. 1 | CONTROL SECTION: 11012 |
| | SHEET NO.: 45 |

SE-NW
SEC. 3

NE-SW
SEC. 3

NW-NW
SEC. 10

ST JOSEPH TWP
T5S-R19W

---PROJ 11-28---

---CS 11012---

NE-NW
SEC 3

CITY OF ST JOSEPH

VILLAGE OF SHOREHAM

NW-SW
SEC. 3

SW-NW
SEC. 3

T5S-R19W

NE-SW
SEC 3

SW-SW
SEC. 3

---PROJ 11-28---

APP N 1/8 LINE

APP W 1/8 LINE

APP W 1/8 LINE

APP N 1/8 LINE

APP S 1/8 LINE

APP SEC LINE

SEC LINE

ROW TO EX ROW

ROW TO EX ROW

66' ROW

33' ROW

PC= 746+91.20

PI= 748+94.00

PT= 750+91.49 = 750+96.80

N13°16' E

66' ROW

ROW TO EX ROW

ROW TO EX ROW

66' ROW

33' ROW

PC= 746+91.20

PI= 748+94.00

PT= 750+91.49 = 750+96.80

N13°16' E

66' ROW

ROW TO EX ROW

ROW TO EX ROW

66' ROW

33' ROW

PC= 746+91.20

PI= 748+94.00

PT= 750+91.49 = 750+96.80

N13°16' E

66' ROW

ROW TO EX ROW

ROW TO EX ROW

66' ROW

33' ROW

PC= 746+91.20

PI= 748+94.00

PT= 750+91.49 = 750+96.80

N13°16' E

66' ROW

ROW TO EX ROW

ROW TO EX ROW

66' ROW

33' ROW

PC= 746+91.20

PI= 748+94.00

PT= 750+91.49 = 750+96.80

N13°16' E

66' ROW

ROW TO EX ROW

ROW TO EX ROW

66' ROW

33' ROW

PC= 746+91.20

PI= 748+94.00

PT= 750+91.49 = 750+96.80

N13°16' E

66' ROW

ROW TO EX ROW

ROW TO EX ROW

66' ROW

33' ROW

PC= 746+91.20

PI= 748+94.00

PT= 750+91.49 = 750+96.80

N13°16' E

66' ROW

ROW TO EX ROW

ROW TO EX ROW

66' ROW

33' ROW

PC= 746+91.20

PI= 748+94.00

PT= 750+91.49 = 750+96.80

N13°16' E

66' ROW

ROW TO EX ROW

ROW TO EX ROW

66' ROW

33' ROW

PC= 746+91.20

PI= 748+94.00

PT= 750+91.49 = 750+96.80

N13°16' E

66' ROW

ROW TO EX ROW

ROW TO EX ROW

66' ROW

33' ROW

PC= 746+91.20

PI= 748+94.00

PT= 750+91.49 = 750+96.80

N13°16' E

66' ROW

ROW TO EX ROW

ROW TO EX ROW

66' ROW

33' ROW

PC= 746+91.20

PI= 748+94.00

PT= 750+91.49 = 750+96.80

N13°16' E

66' ROW

ROW TO EX ROW

ROW TO EX ROW

66' ROW

33' ROW

PC= 746+91.20

PI= 748+94.00

PT= 750+91.49 = 750+96.80

N13°16' E

66' ROW

ROW TO EX ROW

ROW TO EX ROW

66' ROW

33' ROW

PC= 746+91.20

PI= 748+94.00

PT= 750+91.49 = 750+96.80

N13°16' E

66' ROW

ROW TO EX ROW

ROW TO EX ROW

66' ROW

33' ROW

PC= 746+91.20

PI= 748+94.00

PT= 750+91.49 = 750+96.80

N13°16' E

66' ROW

ROW TO EX ROW

ROW TO EX ROW

66' ROW

33' ROW

PC= 746+91.20

PI= 748+94.00

PT= 750+91.49 = 750+96.80

N13°16' E

66' ROW

ROW TO EX ROW

ROW TO EX ROW

66' ROW

33' ROW

PC= 746+91.20

PI= 748+94.00

PT= 750+91.49 = 750+96.80

N13°16' E

66' ROW

ROW TO EX ROW

ROW TO EX ROW

66' ROW

33' ROW

PC= 746+91.20

PI= 748+94.00

PT= 750+91.49 = 750+96.80

N13°16' E

66' ROW

ROW TO EX ROW

ROW TO EX ROW

66' ROW

33' ROW

PC= 746+91.20

PI= 748+94.00

PT= 750+91.49 = 750+96.80

N13°16' E

66' ROW

ROW TO EX ROW

ROW TO EX ROW

66' ROW

33' ROW

PC= 746+91.20

PI= 748+94.00

PT= 750+91.49 = 750+96.80

N13°16' E

66' ROW

ROW TO EX ROW

ROW TO EX ROW

66' ROW

33' ROW

PC= 746+91.20

PI= 748+94.00

PT= 750+91.49 = 750+96.80

N13°16' E

66' ROW

ROW TO EX ROW

ROW TO EX ROW

66' ROW

33' ROW

PC= 746+91.20

PI= 748+94.00

PT= 750+91.49 = 750+96.80

N13°16' E

66' ROW

ROW TO EX ROW

ROW TO EX ROW

66' ROW

33' ROW

PC= 746+91.20

PI= 748+94.00

PT= 750+91.49 = 750+96.80

N13°16' E

66' ROW

ROW TO EX ROW

ROW TO EX ROW

66' ROW

33' ROW

PC= 746+91.20

PI= 748+94.00

PT= 750+91.49 = 750+96.80

N13°16' E

66' ROW

ROW TO EX ROW

ROW TO EX ROW

66' ROW

33' ROW

PC= 746+91.20

PI= 748+94.00

PT= 750+91.49 = 750+96.80

N13°16' E

66' ROW

ROW TO EX ROW

ROW TO EX ROW

66' ROW

33' ROW

PC= 746+91.20

PI= 748+94.00

PT= 750+91.49 = 750+96.80

N13°16' E