

SE-SW
Sec.15

City of
ANN ARBOR

Curve Data (N.B. C)
Δ = 4° 53' 00" L
D = 0° 20' 00" L
T = 732.94'
L = 1465.00'
PI = Sta. 1326 + 81.26

Curve Data (S.B. C)
Δ = 17° 29' 05" L
D = 1° 00' 00" L
T = 881.08'
L = 1748.47'
PI = Sta. 1344 + 53.85

Curve Data (S.B. C)
Δ = 1° 44' 00" L
D = 0° 13' 00" L
T = 400.03'
L = 800.00'
PI = Sta. 1357 + 21.27

Curve Data (S.B. C)
Δ = 61° 06' 00" L
D = 2° 26' 42" L
T = 1383.18'
L = 2499.09'
PI = Sta. 1375 + 04.42

C.S. 81074

Parcel	Grantor	Inst.	Date Recorded	Liber-Page	L.A.
C-78	Luman A. Culp	D	4-24-61	946-346	L.A.
79	Lorena Zeeb	"	9-12-61	962-3	"
79A	"	"	"	962-5	"
79B	"	"	"	961-638	Cov.
C-81	Laura M. Balgos	D	4-24-61	946-348	L.A.
82	Norman J. Wenk	"	6-26-61	953-197	"
84	Dusan K. Yatch	"	8-17-61	958-562	"
84B	"	"	"	958-560	"
84C	"	"	"	958-538	Cov.
85	Florence M. Poplins	D	6-26-61	953-195	L.A.
85A	"	"	"	953-193	"

C.S. 81103

Parcel	Grantor	Inst.	Date Recorded	Liber-Page	L.A.
* 1	Walter H. Zeeb	D	9-12-61	962-7	L.A.

* Error in description

SW-NE
Sec.14

NW-NE
Sec.14

SW-SE
Sec.11

EXCESS SALES

PARCEL	SOLD TO	INST.	DATE	SALE NO.	LIBER-PAGE	L.A.
A	H. WEBER	D	04-15-75	8-139-A-6C	1507-341	LA

UTILITY EASEMENT
JOURNAL 8-U-8
L 999 P 355,356
12-01-61

Note:
Easements granted to Detroit Edison Co.
across that part of the following parcels
lying outside L.A. R.O.W. Lines.
C-78, 79, 79A, 79B, 84B, 84C, 85A.
12-1-61

For continuation of
U.S.-23 north and it's
connection with M-14
see sheet 118.

SE-NE
Sec.14

NE-NE
Sec.14

SE-SE
Sec.11

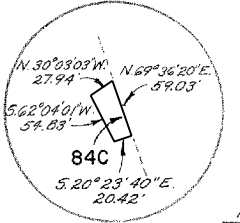

P.O.E. C.S. 81074
Sta. 1335 + 00

P.O.B. C.S. 81103
Sta. 1335 + 00

Curve Data (Ramp A)
Δ = 80° 42' 15" R.
D = 4° 00' 21" L
T = 1215.26'
L = 2014.67'
PI = Sta. 404 + 23.51

C.S. 81074, 81103

RIGHT-OF-WAY MAP

DRAWN BY: WILCOX	CHECKED BY:	ROUTE	PROJ. JOB #	CONTROL SECTION	SHEET NO.
LAST REVISION DATE: APRIL 2005		US-23		81074	31
COUNTY: WASHTENAW				81103	
FILE NO. 1	81-R-1				